

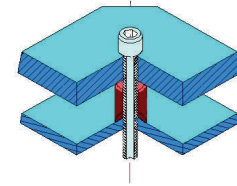

## NYLTITE UNHEADED SLEEVES:

- Economical standoff
- Effective protector as a grommet
- Thin wall bushing
- Insulator/ isolator

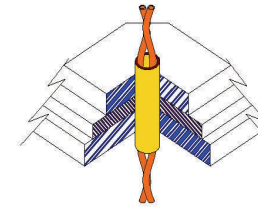

PART NUMBER (-L)	SCREW SIZE	NOMINAL (DEC. INCH)	ID +.004/- .003	W +/- .002	OD +/- .008
NUS-01-XX	1	.073	.075	.012	.099
NUS-02-XX	2	.086	.088	.012	.112
NUS-03-XX	3	.099	.101	.012	.125
NUS-04-XX	4	.112	.116	.013	.140
NUS-05-XX	5	.125	.129	.014	.159
NUS-06-XX	6	.138	.142	.015	.172
NUS-08-XX	8	.164	.168	.015	.198
NUS-10-XX	10	.190	.194	.017	.228
NUS-12-XX	12	.216	.220	.017	.254
NUS-14-XX	1/4	.250	.252	.020	.292
NUS-15-XX	5/16	.313	.316	.020	.356
NUS-16-XX	3/8	.375	.379	.020	.419
NUS-17-XX	7/16	.438	.441	.022	.486
NUS-18-XX	1/2	.500	.504	.022	.548
NUS-19-XX	5/8	.625	.629	.025	.679
NUS-20-XX	3/4	.750	.754	.028	.810
NUS-21-XX	7/8	.875	.890	.032	.954
NUS-22-XX	1.0	1.000	1.005	.035	1.075

LENGTH CODE (XX)	L +/- .008
05	.062
1	.125
2	.250
3	.375
4	.500
5	.625
6	.750
7	.875
8	1.000
9	1.125
10	1.250
11	1.375
12	1.500
13	1.625
14	1.750
15	1.875
16	2.000
17	2.125
18	2.250
19	2.375

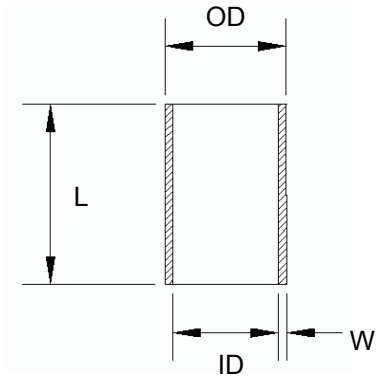

**TYPICAL PART NUMBER :**  
 NUS-10-4  
 NYLTITE UNHEADED SLEEVE FOR  
 #10 SCREW, 1/2" LONG