

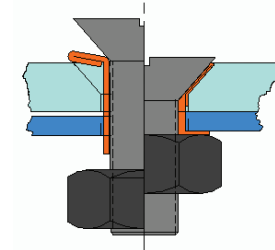

NYLTITE FLAT HEADED SLEEVES:

- Lock and seal with reduced footprint
- Act as an anti-rotational device
- Assist with vibration damping
- Versatile and effective

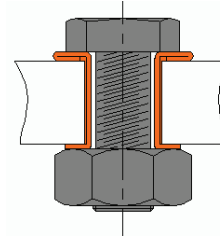

PART NUMBER (-L)	SCREW SIZE	NOMINAL (DEC. INCH)	ID +.004/- .003	W +/- .002	OD +/- .008	FH (REF)	FD +.020/- .010
NFS-01-XX	-	-	-	-	-	-	-
NFS-02-XX	2	.086	.088	.012	.112	.026	.175
NFS-03-XX	3	.099	.101	.012	.125	.026	.185
NFS-04-XX	4	.112	.116	.013	.140	.029	.195
NFS-05-XX	5	.125	.129	.014	.159	.031	.210
NFS-06-XX	6	.138	.142	.015	.172	.033	.225
NFS-08-XX	8	.164	.168	.015	.198	.033	.270
NFS-10-XX	10	.190	.194	.017	.228	.037	.300
NFS-12-XX	12	.216	.220	.017	.254	.037	.330
NFS-14-XX	1/4	.250	.252	.020	.292	.044	.365
NFS-15-XX	5/16	.313	.316	.020	.356	.044	.460
NFS-16-XX	3/8	.375	.379	.020	.419	.044	.535
NFS-17-XX	7/16	.438	.441	.022	.486	.048	.600
NFS-18-XX	1/2	.500	.504	.022	.548	.048	.645
NFS-19-XX	5/8	.625	.629	.025	.679	.055	.800
NFS-20-XX	3/4	.750	.754	.028	.810	.062	.935
NFS-21-XX	7/8	.875	.890	.032	.954	.062	1.030
NFS-22-XX	1.0	1.000	1.005	.035	1.075	.062	1.280

LENGTH CODE (XX)	L +/- .008
-	-
1	.125
2	.250
3	.375
4	.500
5	.625
6	.750
7	.875
8	1.000
9	1.125
10	1.250
11	1.375
12	1.500
13	1.625
14	1.750
15	1.875
16	2.000
17	2.125
18	2.250
19	2.375

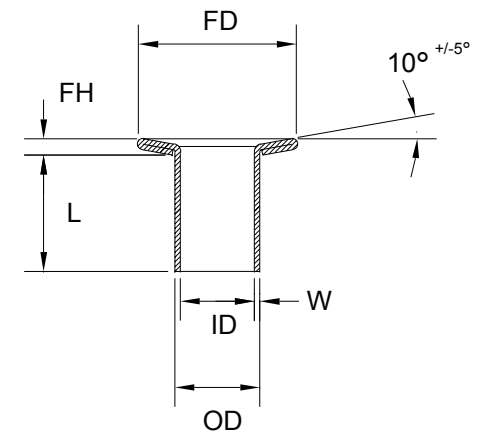

TYPICAL PART NUMBER :
 NFS-10-4

NYLTITE FLAT HEADED SLEEVE FOR
 #10 SCREW, 1/2" LONG