

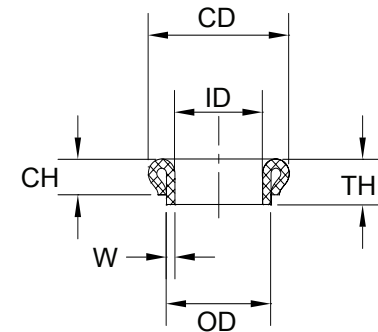

NYLTITE ROLLED COLLARS:

- Lock and seal
- Act as an anti-rotational device
- Assist with vibration damping
- Are available as full assemblies or components

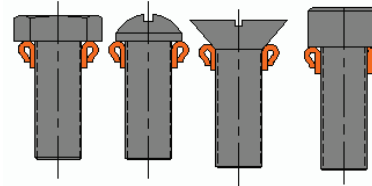

PART NUMBER	SCREW SIZE	NOMINAL (DEC. INCH)	ID +.004/- .003	W +/- .002	OD +/- .008	CD +/- .030	TH +/- .030	CH (REF)	DRILL SIZE
NRC-01	1	.073	.075	.012	.099	.165	.060	.048	7/64
NRC-02	2	.086	.088	.012	.112	.175	.065	.050	#31
NRC-03	3	.099	.101	.012	.125	.185	.070	.055	#29
NRC-04	4	.112	.116	.013	.140	.195	.080	.065	#25
NRC-05	5	.125	.129	.014	.159	.210	.085	.070	#19
NRC-06	6	.138	.142	.015	.172	.225	.095	.075	#15
NRC-08	8	.164	.168	.015	.198	.270	.115	.080	#5
NRC-10	10	.190	.194	.017	.228	.300	.115	.080	A
NRC-12	12	.216	.220	.017	.254	.330	.125	.100	G
NRC-14	1/4	.250	.252	.020	.292	.365	.125	.100	N
NRC-15	5/16	.313	.316	.020	.356	.460	.130	.105	T
NRC-16	3/8	.375	.379	.020	.419	.535	.160	.125	27/64
NRC-17	7/16	.438	.441	.022	.486	.600	.170	.135	31/64
NRC-18	1/2	.500	.504	.022	.548	.645	.195	.155	9/16
NRC-19	5/8	.625	.629	.025	.679	.800	.210	.160	11/16
NRC-20	3/4	.750	.754	.028	.810	.935	.220	.170	13/16
NRC-21	7/8	.875	.890	.032	.954	1.030	.240	.180	15/16
NRC-22	1.0	1.000	1.005	.035	1.075	1.280	.250	.185	1 3/32

TYPICAL PART NUMBER :
 NRC-10-4

NYLTITE ROLLED COLLAR
 FOR #10 SCREW

PLEASE NOTE THE DRILL SIZES ARE TO BE USED AS A REFERENCE ONLY. EACH APPLICATION IS DIFFERENT AND REQUIRES YOUR TESTING TO ENSURE PROPER FIT FOR YOUR APPLICATION.



NYLTITE ROLLED COLLARS:

- Lock and seal
- Act as an anti-rotational device
- Assist with vibration damping
- Are available as full assemblies or components

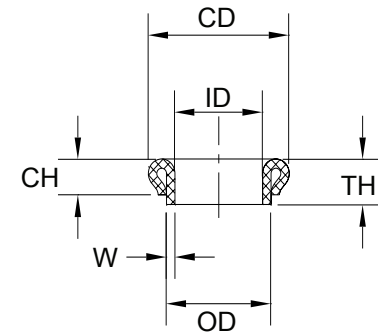
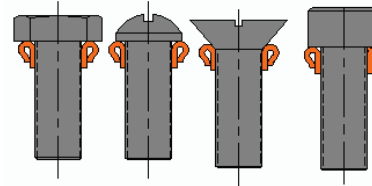

METRIC SIZES

PART NUMBER	SCREW SIZE	NOMINAL (DEC. INCH)	ID +.004/- .003	W +/- .002	OD +/- .008	CD +/- .030	TH +/- .030	CH (REF)
11653	M2	.078	.078	.012	.110	.161	.070	.055
NRC-02.5M	M2.5	.098	.098	.012	.122	.174	.080	.064
10079	M3	.118	.118	.013	.144	.198	.080	.064
10081	M4	.157	.157	.015	.187	.245	.108	.082
11751	M5	.196	.196	.017	.230	.310	.115	.092
10097	M6	.236	.236	.017	.270	.354	.122	.012
11750	M8	.3153	.315	.020	.355	.472	.132	.105
11751	M10	.393	.393	.020	.433	.509	.156	.124
10235	M12	.473	.473	.022	.517	.615	.175	.140
NRC14M	M14	.551	.551	.022	.595	.700	.192	.155
11652	M16	.629	.629	.025	.679	.800	.210	.160

TYPICAL PART NUMBER :
10081

NYLTITE ROLLED COLLAR FOR
M4 SCREW